



Lindisfarne community garden project proposal

Background information

The idea of developing local community gardens on the eastern shore was identified in Council's Positive Ageing Plan, and follows successful community garden demonstrations in Lenah Valley and Tarooma.

Key organisers involved in the Tarooma community garden project approached and assisted Council to develop criteria and assess possible sites for a community garden on Council land. A number of locations were identified and their suitability was assessed in terms of the following criteria:

- ease of access to the site – disability considerations, location of major public transport routes and other goods or services;
- visibility of the site – Tarooma demonstrated a high visibility site was more frequently visited and well utilised;
- design of the site – location with adequate sunlight and minimal impact on existing landscape and vegetation; and
- degree of community participation – level of support from local groups, schools and local activity centres.

Site visits and assessments were undertaken in the City. In respect to the first three criteria Beltana Park in Lindisfarne rated the most favourable. Council anticipates a high level of community participation in the project given its accessible location to natural meeting places, and the number of community groups in the area.

Council is looking for individuals, community groups and businesses in the local area that are willing to support the community garden concept and would like to register their interest in being involved. A gathering of interested parties will be organised early in the New Year to start implementing the ideas we have collected.

A draft design for a Lindisfarne community garden has been provided on the back of this sheet.

If you have any questions or require further information, please contact Suzanne Schulz on 62458664 or sschulz@ccc.tas.gov.au or Julie Andersson on 62458780 or jandersson@ccc.tas.gov.au.

SUGGESTED LAYOUT FOR PROPOSED LINDISFARNE NEIGHBOURHOOD GARDEN. ENTRY FROM REAR OF ACTIVITIES CENTRE ON BELTANA PARK by DAVID STEPHEN

SIZE APPROX. 20m X 50m

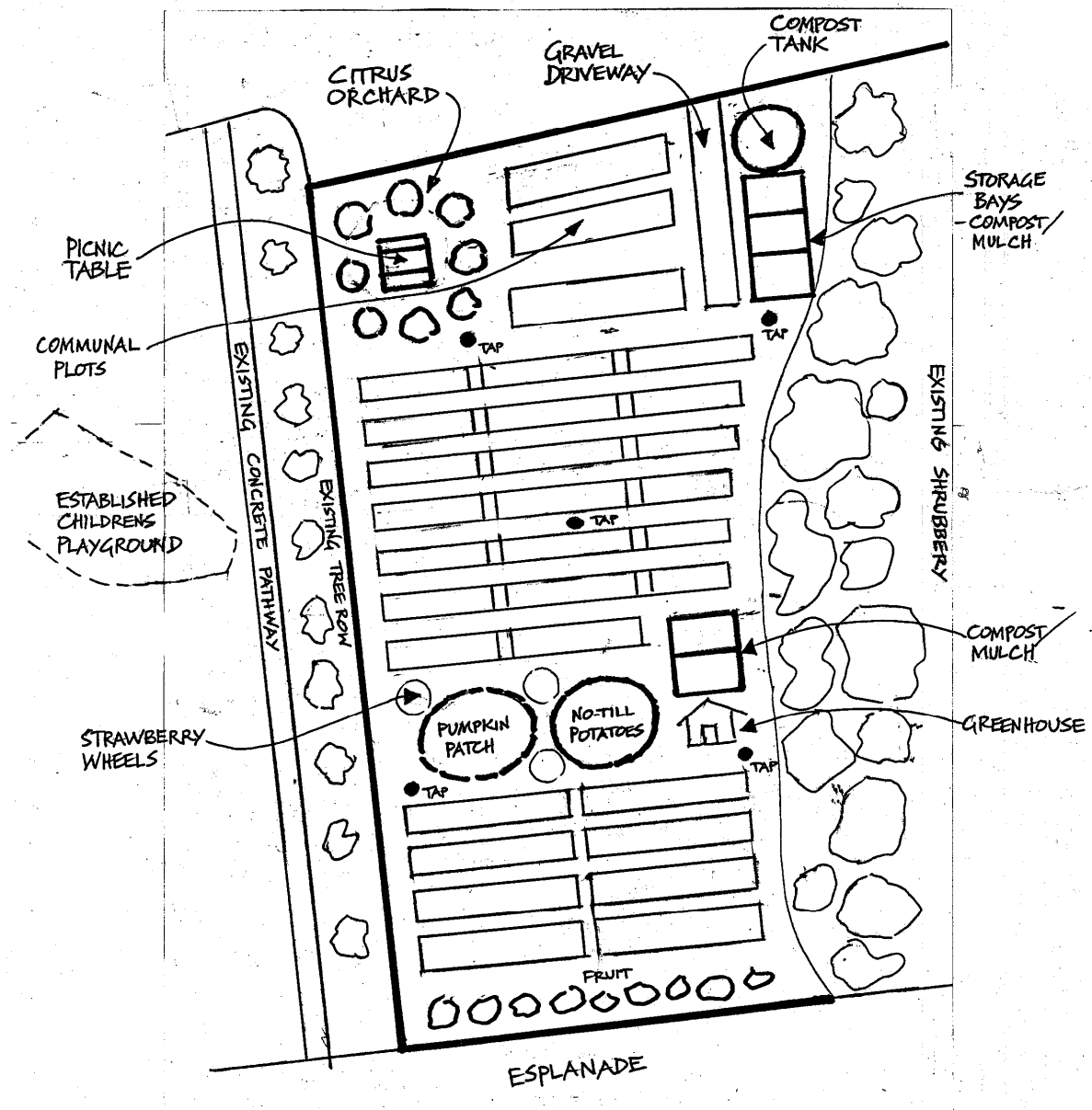

Lindisfarne community garden survey - please return by Friday the 27th of November 2009

What things would you like to see included in a community garden in
Lindisfarne?

In what capacity would you like to be involved?

- Building – manual labour
- Personal plot – maintaining a small raised garden bed?
- Management – facilitating maintenance and community involvement in the garden???
- Other (please specify): _____

What other kinds of resources are you willing to contribute towards the
community garden?

- Skills
- Tools / Equipment
- Materials
- Time
- Other (please specify): _____

Are you or your organisation interested in putting your name down for a plot
within the garden? Y / N

ADDITIONAL COMMENTS:

CONTACT DETAILS:

Organisation name (for groups interested in participating): _____

Name: _____

Address: _____

Phone number: _____ Email: _____

Would you like to be on an email contact list? Y / N

Privacy Statement: The personal information on this form is required by Council for *the community garden survey*. We will only use your personal information for this and related purposes. If this information is not provided, we may not be able to deal with this matter. You may access and/or amend your personal information at any time. How we use this information is explained in our Privacy Policy, which is available at www.ccc.tas.gov.au or at Council offices.

Thank you for your participation in this project.